

**Caratteristiche:**

Diffusori lineari a feritoie con deflettore rotativo a profilo aerodinamico per medio-piccole portate.

Costruzione:

Alluminio anodizzato estruso, deflettore in polipropilene nero RAL 9005.

Impiego:

A soffitto, in mandata e ripresa. Altezza di installazione: 2,6 - 4,0 m.

Fissaggio:

- Mediante viti frontali.
- Con staffa interna mobile.
- Con molle all'interno del plenum.

Accessori:

- Plenum di raccordo in acciaio zincato con isolamento.
- Deflettore RAL 9003

Characteristics:

Linear slot diffusers with aifoil section rotating deflector for medium-small airflow.

Construction:

Anodized extruded aluminium, deflector made of RAL 9005 black polypropylene.

Utilization:

For ceiling installation and for air intake and delivery. Installation height: 2,6 - 4,0 m

Fixing:

- By frontal screws.
- By inner mounting mobile bracket.
- By springs inside the plenum.

Accessories:

- Galvanized steel connecting plenum with insulation.
- Deflector RAL 9003.

PREZZI / PRICES

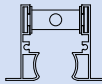
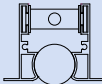
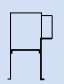
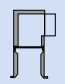
					
Feritoie Slots	Lunghezza Length	DLPCN 10	DLPCN 20	PDLCN	PDLCNI
N.	mm*	€	€	€	€
1	800	-	-	-	-
	1000	-	-	-	-
	1500	-	-	-	-
	2000	-	-	-	-
2	800	-	-	-	-
	1000	-	-	-	-
	1500	-	-	-	-
	2000	-	-	-	-
3	800	-	-	-	-
	1000	-	-	-	-
	1500	-	-	-	-
	2000	-	-	-	-
4	800	-	-	-	-
	1000	-	-	-	-
	1500	-	-	-	-
	2000	-	-	-	-

*N.B.: le lunghezze riportate sono da intendere passaggio aria

*The lengths are actual neck sizes

VERNICIATURA:

Colori RAL 9010 - 9016: + 15%
Altri colori: prezzi a richiesta

PAINTING:

Color RAL 9010 - 9016: + 15%
Different colors: prices on request

MODELLI:

DLPCN 10: Diffusore standard (1)
DLPCN 20: Diffusore con deflettore (1) (2)

MODELS:

DLPCN 10: Standard diffuser (without sliding control damper and deflectors) (1)
DLPCN 20: Diffuser with deflectors (1) (2)

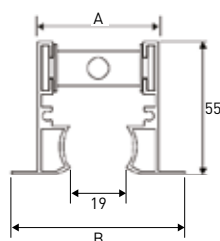
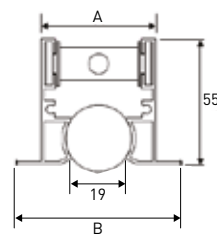
DISEGNI / DRAWINGS**DLPCN 10****DLPCN 20**

MISURE / MEASURES

N. feritoie N. slots	Lunghezza mm Length mm	Ø collarino est. N. collarini Ø spigot N. spitos	A mm	B mm	S mm	NR. CM Molle Spring	NR. CVL-CN Cavalletti Mounting brackets
1	800	98-1	39	56	43	2	2
	1000	98-1				2	2
	1500	98-2				2	2
	2000	98-3				3	2
2	800	148-1	77	94	81	4	2
	1000	148-2				4	2
	1500	148-3				4	2
	2000	148-4				6	2
3	800	198-1	115	132	119	4	2
	1000	198-2				4	2
	1500	198-3				6	2
	2000	198-4				6	3
4	800	198-2	153	170	157	4	2
	1000	198-2				4	2
	1500	198-3				6	2
	2000	198-4				6	3

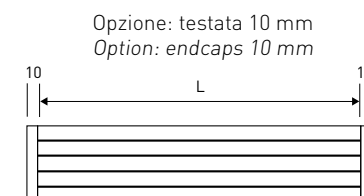
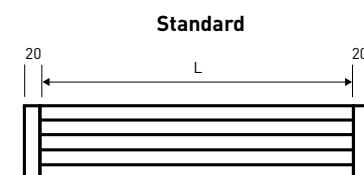
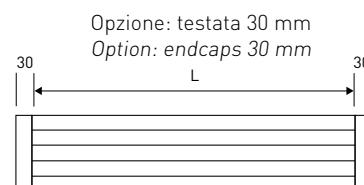

PDLCN 1

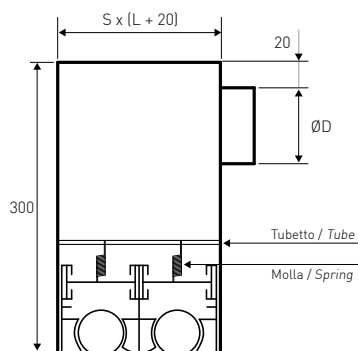

Fissaggio al plenum con molle CM
Fixing the plenum by springs CM

PDLCN 2

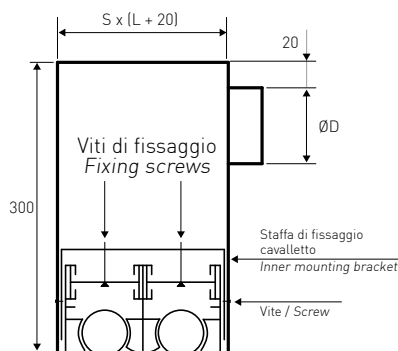

Fissaggio al plenum con staffe CVL-CN caval
Fixing the plenum by inner
mounting brackets CVL-CN



Vista laterale posizione CVL-CN
lunghezza sino 1500 mm
Side view position CVL-CN
length to 1500 mm

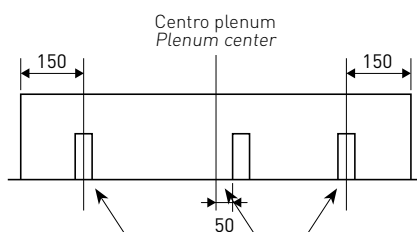

Vista laterale posizione CVL-CN
lunghezza oltre 1500 mm
Side view position CVL-CN
length over 1500 mm

DIAGRAMMA SCELTA RAPIDA / QUICK SELECTION DIAGRAM



TABELLA DI SELEZIONE / SELECTION TABLE

Modello Model	A _x [m²]	Q [m³/h]		L _{WA} [dB(A)]		X _{10,25} [m]		Dp _t * [Pa]	
		min	max	min	max	min	max	min	max
DLPCN 1-1000	0,00620	60	140	-	42	3,3	7,7	10	50
DLPCN 2-1000	0,01240	120	260	23	44	4,3	9,4	10	50
DLPCN 3-1000	0,01860	170	370	24	46	4,8	10,4	10	50
DLPCN 4-1000	0,02480	210	470	24	46	5,0	11,1	10	50

*senza equalizzatore e serranda completamente aperta - without equalizer and calibration damper completely open

ACCESSORI / ACCESSORIES

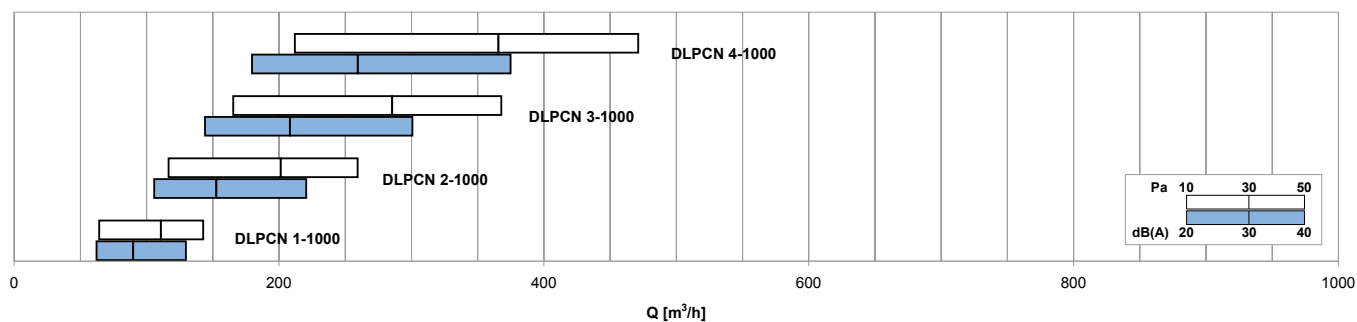
		€
CVL-CN 1 - 4 Feritoie 1 - 4 Slots		-
CM Molla Spring		-
CG Gancio Hook		-
CC-CN Kit Continuità (2 pezzi) Kit continuity (2 pieces)		-

SOLUZIONE DI CONTINUITÀ / CONTINUITY SOLUTION

Punto di bloccaggio
Clamping point

1

Inserire la staffa nel profilo nel senso indicato.
Insert the bracket into the profile in the direction indicated.

2

Inserire la staffa sino a far penetrare di 10/15 mm il punto di bloccaggio.
Insert the bracket to penetrate up to 10/15 mm the clamping point.

3

Unire i 2 elementi.
Combine the 2 parts.

Punto di giunzione
Connection point